

NOTE:
THIS SITE PLAN WAS GENERATED WITHOUT THE USE OF A SURVEY.
PROPERTY LINES, POWER & TELCO UTILITY POINT
CONNECTIONS/ROUTES AND EASEMENTS SHOWN ON THESE PLANS
ARE ESTIMATED. ALL ITEMS AND DIMENSIONS SHOULD BE VERIFIED
IN THE FIELD.



3500 DEER CREEK RD
PALO ALTO, CA 94304
(650) 681-5000



520 South Main Street, Suite 2531
Akron, OH 44311
330.572.2100 Fax: 330.572.2102

PROJECT NO: 2015560.01
DRAWN BY: RJB
CHECKED BY: LAS

E	03.18.16	ISSUED SIGNED/SEALED
D	03.04.16	ISSUED FOR 100% REVIEW
C	01.29.16	ISSUED FOR 90% REVIEW
B	12.15.15	CLIENT REVISIONS
A	12.14.15	ISSUED FOR 90% REVIEW
REV	DATE	DESCRIPTION

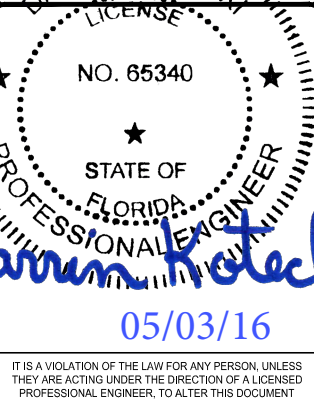

499 BAYFRONT PLACE
NAPLES, FL 34102

SHEET TITLE
OVERALL
SITE PLAN

SHEET NUMBER
C-1



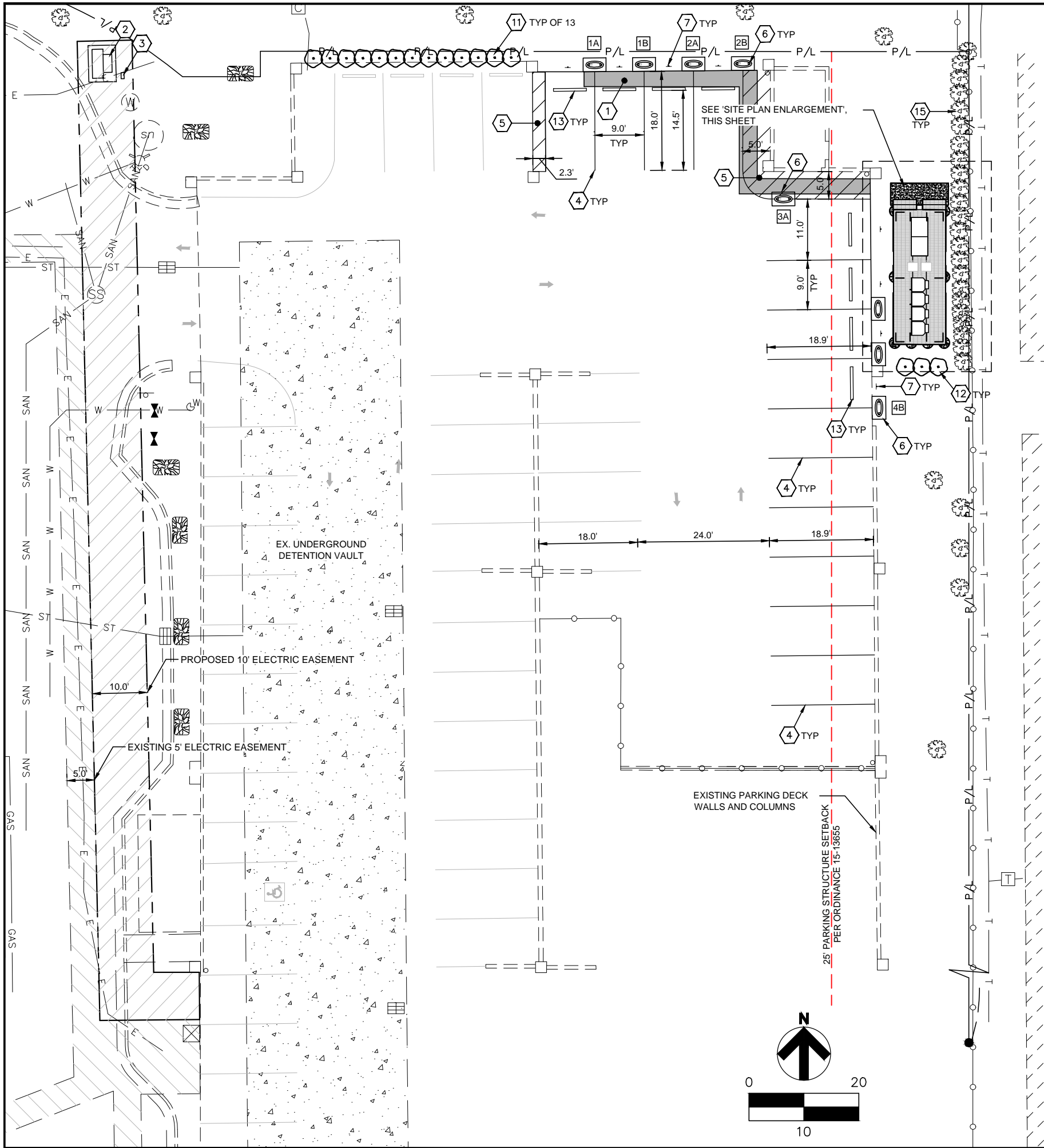

CONSTRUCTION KEYNOTES

- 1 PROPOSED ASPHALT PAVEMENT. MATCH EXISTING PAVEMENT SECTION IN TYPE AND DEPTH.
- 2 PROPOSED 500 KVA ELECTRICAL UTILITY TRANSFORMER 480/277V, 3 Ø, 4 W ON CONCRETE PAD. TRANSFORMER AND PAD TO BE FURNISHED AND INSTALLED BY UTILITY COMPANY.
- 3 PROPOSED ELECTRIC METER MOUNTED TO UNISTRUT PER ELECTRIC COMPANY SPECIFICATIONS AND DETAIL 1, SHEET C-6.
- 4 PROPOSED PAINTED 4" WIDE SOLID WHITE STRIPE.
- 5 PROPOSED PAINTED 4" WIDE WHITE TRANSVERSE STRIPING. STRIPING SHALL BE 3'-0" O.C. @ 45°.
- 6 PROPOSED TESLA ILLUMINATED CHARGE POST W/ CONCRETE PAD & PEDESTAL (TYP. OF 8) PER DETAILS 4 - 6, SHEET C-5.
- 7 PROPOSED TESLA NON-ILLUMINATED PARKING SIGN (TYP. OF 8) PER DETAIL 2, SHEET C-6.
- 8 PROPOSED TESLA SUPERCHARGER CABINET (TYP. OF 4) PER DETAILS 1 AND 3, SHEET C-5.
- 9 PROPOSED QED SWITCHGEAR ASSEMBLY PER DETAIL A, SHEET E-4.
- 10 PROPOSED 2'-0" HIGH EQUIPMENT PLATFORM PER DETAIL SHEETS S-1 THRU S-3.
- 11 PROPOSED (TYP. OF 11) CHRYSOALANUS ICACO 'COCOPLUM' - 36" HT. MIN. @ 36" O/C. MAINTENANCE (SHEARED HEIGHT, SHAPE, ETC.) TO MATCH EXISTING CONDITIONS.
- 12 PROPOSED (TYP. OF 3) CHRYSOALANUS ICACO 'COCOPLUM' - 36" HT. MIN. @ 36" O/C. SHRUBS ARE NOT TO BE SHEARED TO FORM FORMAL HEDGE FOR SCREENING.
- 13 PROPOSED RUBBER CURB STOP (TYP. OF 8) PER DETAIL 5, SHEET C-6. INSTALL BACK EDGE OF RUBBER CURB STOP 3'-9" FROM EDGE OF CHARGE POST PEDESTAL.
- 14 SPACE FOR AUTO-TRANSFORMERS (IF REQUIRED). CONTRACTOR SHALL PROVIDE (4) 3" CONDUIT STUBS AS SHOWN ON PLAN.
- 15 EXISTING ROW OF MATURE FICUS BENJAMINA 'WEeping FIG' PER ORIGINAL DESIGN DRAWINGS (DATED 10/24/98). EXISTING LANDSCAPING TO BE USED AS SCREENING BUFFER ALONG EAST P/L

PARKING STALL SCHEDULE	
EXISTING STANDARD STALLS REMOVED AS A RESULT OF THIS PROJECT	15
PROPOSED TESLA STALLS	8
PROPOSED STD. STALLS	7
NET REDUCTION IN STALLS	0

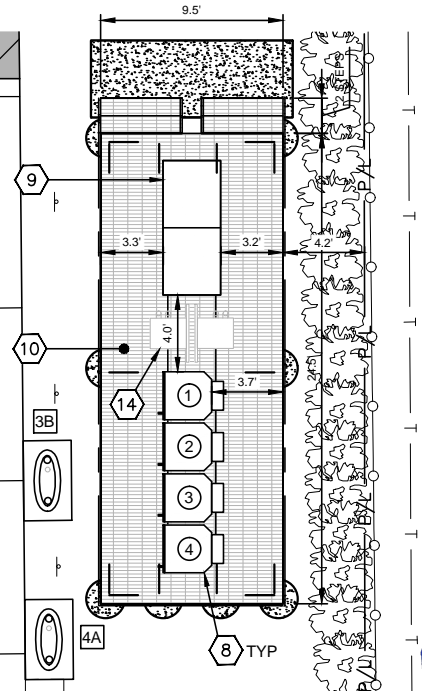

SITE PLAN ENLARGEMENT
1"=10'

CHARGING POST CIRCUIT SCHEDULE		
SUPERCHARGER	CHARGE POST	DEDICATED/ENABLED
①	1A	DEDICATED
	1B	DEDICATED
②	2A	DEDICATED
	2B	DEDICATED
③	3A	DEDICATED
	3B	DEDICATED
④	4A	DEDICATED
	4B	DEDICATED

TESLA EQUIPMENT SCHEDULE			
TESLA EQUIPMENT	DESCRIPTION	PART NUMBER	QUANTITY
SUPERCHARGER CABINET	GEN 2 L-N SUPERCHARGER	1033026-04-E	4
CHARGE POST BOLLARDS	BOLT-DOWN BOLLARDS	1024070-01-D	8
CHARGE POST JUNCTION BOX	SINGLE CONDUCTOR	1048082-01-A	8
CHARGE POST DOCK	NORTH AMERICA	1028384-00-C	8



3500 DEER CREEK RD
PALO ALTO, CA 94304
(650) 681-5000



520 South Main Street, Suite 2531
Akron, OH 44311
330.572.2100 Fax: 330.572.2102

PROJECT NO:	2015560.01
DRAWN BY:	RJB
CHECKED BY:	LAS

E	03.18.16	ISSUED SIGNED/SEALED
D	03.04.16	ISSUED FOR 100% REVIEW
C	01.29.16	ISSUED FOR 90% REVIEW
B	12.15.15	CLIENT REVISIONS
A	10.24.98	ISSUED FOR 50% REVIEW

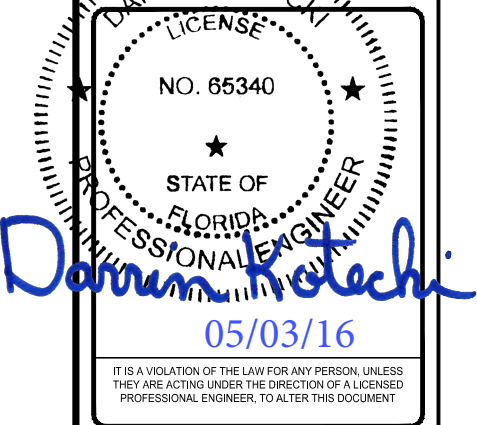

499 BAYFRONT PLACE
NAPLES, FL 34102

SHEET TITLE
PROPOSED
SITE PLAN

SHEET NUMBER
C-3

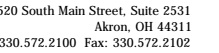

E	03.18.16	ISSUED SIGNED/SEALED
D	03.04.16	ISSUED FOR 100% REVIEW
C	01.29.16	ISSUED FOR 90% REVIEW
B	12.15.15	CLIENT REVISIONS
A	12.08.15	ISSUED FOR 50% REVIEW
REV	DATE	DESCRIPTION

IT IS A VIOLATION OF THE LAW FOR ANY PERSON, UNLESS
THEY ARE ACTING UNDER THE DIRECTION OF A LICENSED
PROFESSIONAL ENGINEER, TO ALTER THIS DOCUMENT

PS-1

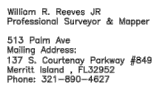

Project No.	15999011	Drawn By: JPN	Date: 11/21/15
		Checked By: WRR	Sheet 1 of 1